



## Features and Benefits

Center frequency: 802MHz

I.L: 3dB Max.

Operating temperature: -20°C to +85°C

Size: 3x3x1.4mm

Package type: Surface Mount



## Typical Applications

IOT

Cellular

Telecom

4G/LTE

Wireless Communication

WLAN

Base Station

Radar

## Mechanical Drawing & Pin Connections

Drawing No: MD240080-1

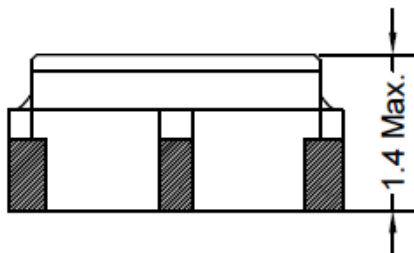
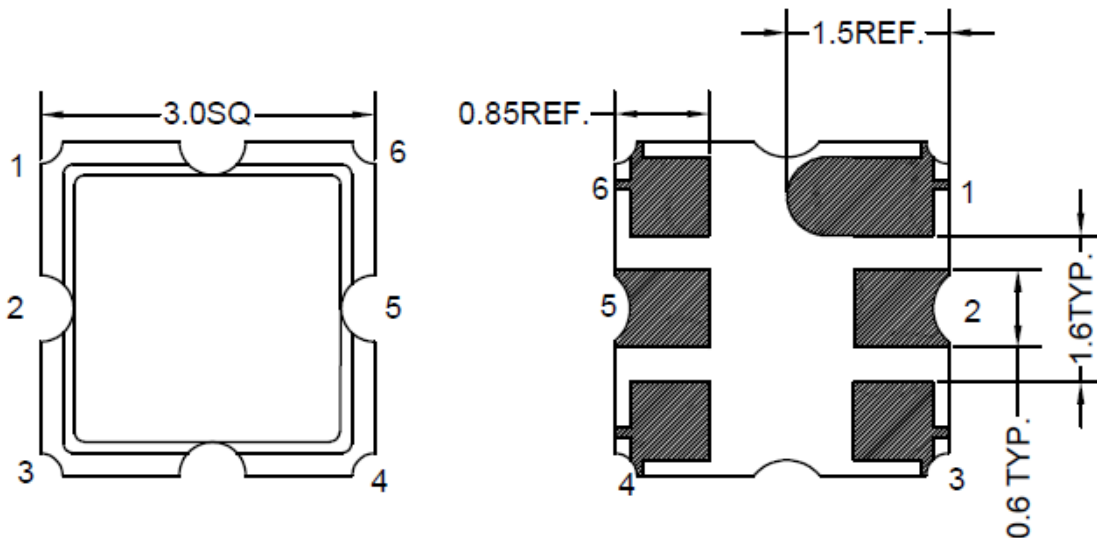

PIN	Function
#2	INPUT
#5	OUTPUT
Others	GND

Unit in mm

1mm = 0.0394 inches

Not Specified Tolerance:  $\pm 0.2\text{mm}$



## Specifications

Ambient Temperature: 25°C

Parameter		Min.	Typical	Max.	Units
Center Frequency	Fc		802		MHz
Insertion Loss (794~810 MHz)	IL		1.65	3	dB
Passband (794~810 MHz)		16	32		MHz
Attenuation (Reference level from 0 dB)					
100~722	MHz	50	58		dB
882~1200	MHz	50	55		dB
Temperature Coefficient of Frequency			-36		ppm/°C
Source Impedance	Z <sub>s</sub>		50		ohm
Load Impedance	Z <sub>L</sub>		50		ohm
Input Power Level			10		dBm
DC Voltage			3		V
Operating Temperature Range		-20		+85	°C
Storage Temperature Range		-55		+125	°C
Moisture Sensitivity Level		Level 1(MSL1)			