



## Features and Benefits

Center frequency: 876.5MHz

I.L: 4dB Max.

Operating temperature: -30°C to +85°C

Size: 3x3x1.4mm

Package type: Surface Mount



## Typical Applications

IOT

Cellular

Telecom

4G/LTE

Wireless Communication

WLAN

Base Station

Radar

## Mechanical Drawing & Pin Connections

Drawing No: MD240080-1

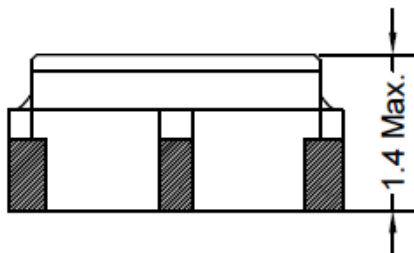
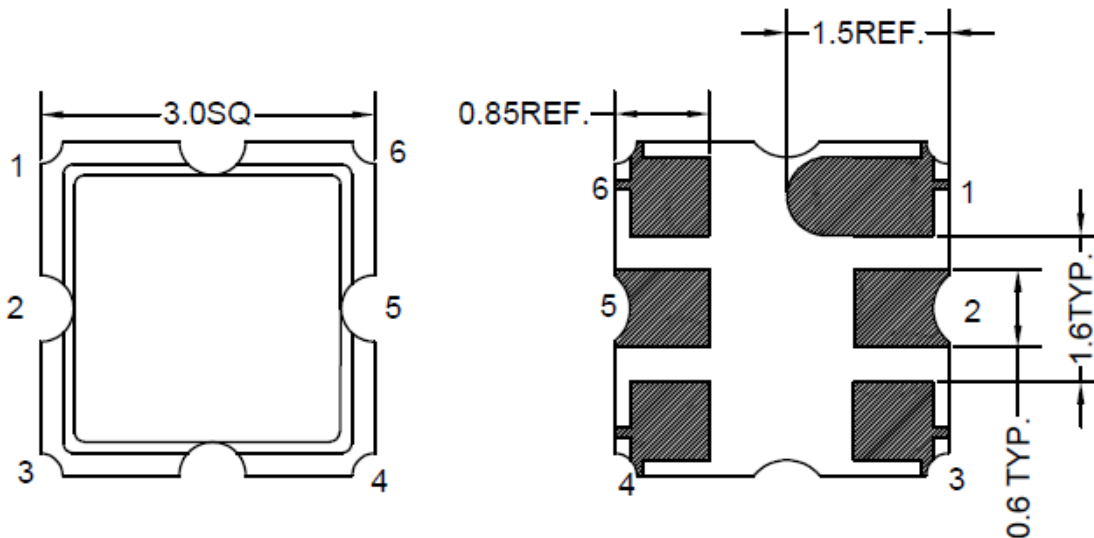

PIN	Function
#2	INPUT
#5	OUTPUT
Others	GND

Unit in mm

1mm = 0.0394 inches

Not Specified Tolerance:  $\pm 0.2\text{mm}$



## Specifications

Parameter		Min.	Typical	Max.	Units
Center Frequency	Fc		876.5		MHz
Insertion Loss (859~894 MHz)	IL		3.3	4	dB
Amplitude Ripple (859~894 MHz)			1.6	2	dB
Attenuation (Reference level from 0 dB)					
10~840	MHz	40	46		dB
920~1000	MHz	30	33		dB
1000~2600	MHz	25	33		dB
Input/Output Impedance			50		ohm
Input Power Level			10		dBm
DC Voltage			3		V
Operating Temperature Range		-30		+85	°C
Storage Temperature Range		-40		+85	°C