



Features and Benefits

Center frequency: 901.5MHz

I.L: 4dB Max.

Operating temperature: -40°C to +85°C

Size: 3x3x1.4mm

Package type: Surface Mount



Typical Applications

IOT

Cellular

Telecom

4G/LTE

Wireless Communication

WLAN

Base Station

Radar

Mechanical Drawing & Pin Connections

Drawing No: MD240080-1

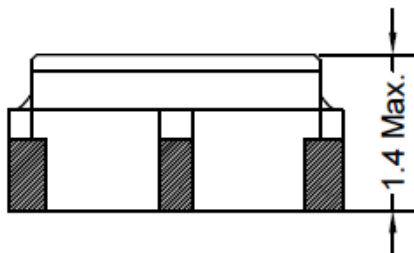
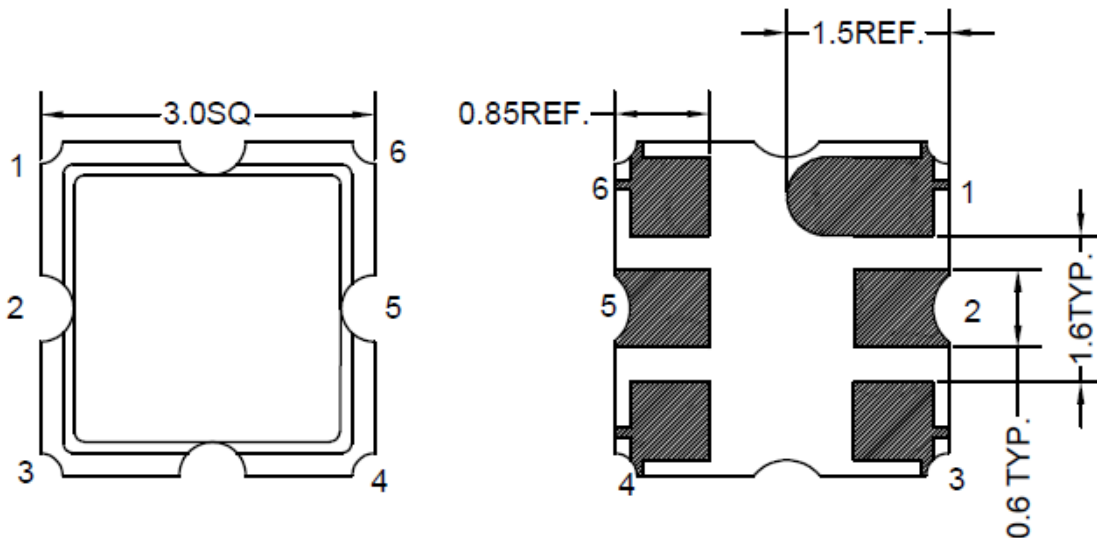

PIN	Function
#2	INPUT
#5	OUTPUT
Others	GND

Unit in mm

1mm = 0.0394 inches

Not Specified Tolerance: $\pm 0.2\text{mm}$



Specifications

Test Temperature 25°C

Parameter		Min.	Typical	Max.	Units	Note
Center Frequency	Fc		901.5		MHz	
Insertion Loss (901~902 MHz)	IL		3	4	dB	
Amplitude Ripple (901~902 MHz)			1	2	dB	
VSWR (901~902 MHz)			1.3	2		23~27 °C
Attenuation (Reference level from 0 dB)						
50~861	MHz	45	50		dB	
861~890	MHz	35	40		dB	
930~941	MHz	45	50		dB	
941~1000	MHz	45	50		dB	
Temperature Coefficient of Frequency			-36		ppm/°C	
Terminating Source Impedance(single)	Z _S		50		ohm	
Terminating Load Impedance(single)	Z _L		50		ohm	
Input Power Level			10		dBm	
DC Voltage			5		V	
Operating Temperature Range		-40		+85	°C	
Storage Temperature Range		-40		+85	°C	
Moisture Sensitivity Level		Level 1(MSL1)				