



Features and Benefits

Center frequency: 915.5MHz

I.L: 3dB Max.

Operating temperature: -30°C to +85°C

Size: 3x3x1.4mm

Package type: Surface Mount



Typical Applications

IOT

Cellular

Telecom

4G/LTE

Wireless Communication

WLAN

Base Station

Radar

Mechanical Drawing & Pin Connections

Drawing No: MD240080-1

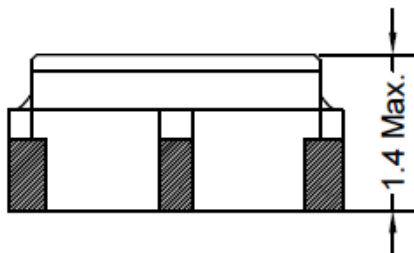
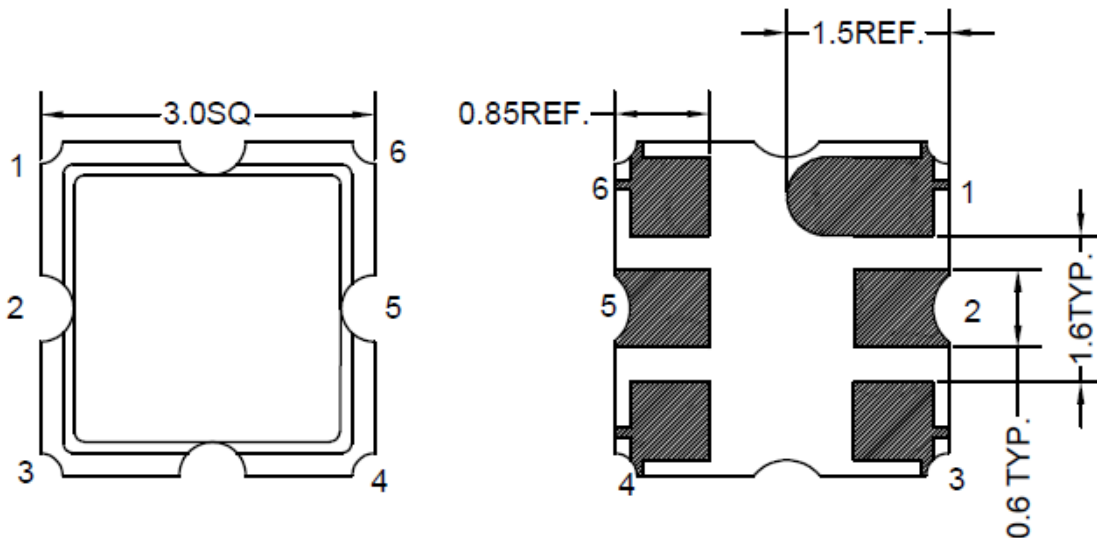

PIN	Function
#2	INPUT
#5	OUTPUT
Others	GND

Unit in mm

1mm = 0.0394 inches

Not Specified Tolerance: $\pm 0.2\text{mm}$



Specifications

Parameter		Min.	Typical	Max.	Units
Center Frequency	Fc		915.5		MHz
Insertion Loss (902.5~928.5 MHz)	IL		2.3	3	dB
Amplitude Ripple (902.5~928.5 MHz)			0.6	1.5	dB
VSWR (902.5~928.5 MHz)			1.7	2.3	
Group Delay at Fc			31	100	ns
Attenuation (Reference level from 0 dB)					
10~849.2	MHz	51	56		dB
849.2~865	MHz	51	53		dB
995~1710.2	MHz	51	54		dB
1710.2~1909.8	MHz	41	55		dB
1909.8~2500	MHz	30	40		dB
Temperature Coefficient of Frequency			-36		ppm/°C
Input Power Level			15		dBm
DC Voltage			5		V
Operating Temperature Range		-30		+85	°C
Storage Temperature Range		-40		+85	°C