

## Features and Benefits

Low phase noise  
Linear tuning characteristics  
Low pushing / Low pulling  
Aqueous washable

## Typical Applications

Base Station  
Cable TV  
Satellite Communications  
UHF Radio Link

## Specifications

| Parameter                      | Units    | Min.  | Typical | Max.  |
|--------------------------------|----------|-------|---------|-------|
| Operating Frequency Range      | MHz      | 325   |         | 775   |
| Output Power                   | dBm      | +11.0 | +14.0   | +17.0 |
| Output Impedance               | $\Omega$ |       | 50      |       |
| Phase Noise @ 10KHz            | dBc/Hz   |       | -105    | -100  |
| @ 100KHz                       | dBc/Hz   |       | -128    | -123  |
| Tuning Voltage (Vt)            | Vdc      | 0.0   |         | 12.0  |
| Tuning Voltage Sensitivity(Kv) | MHz/V    |       | 40-55   |       |
| 2nd Harmonic Suppression       | dBc      |       | -16     |       |
| Power Supply(Vcc)              | Vdc      |       | 8       |       |
| Current                        | mA       |       | 21      | 25    |
| Pushing Figure                 | MHz/V    |       | 0.5     |       |
| Pulling Figure                 | MHz      |       | 2.4     |       |
| Input Capacitance              | pF       |       | 100     |       |
| Operating Temp. Range          | °C       | -40   |         | +85   |

## Mechanical Drawing & Pin Connections

Drawing No: MD14-0084-2

Top View

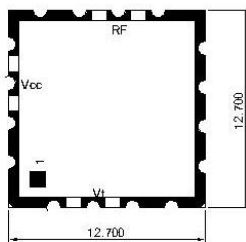

Bottom View

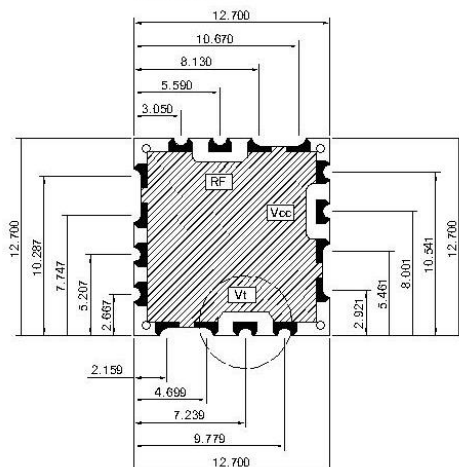

Side View

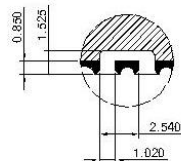

Foot Print

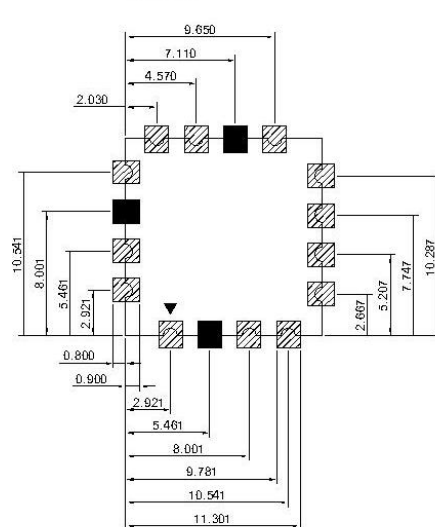

Pin Connections

|        |       |
|--------|-------|
| 2      | Vt    |
| 10     | RFOUT |
| 14     | Vcc   |
| Others | GND   |

Unit : mm

Tuning Curve

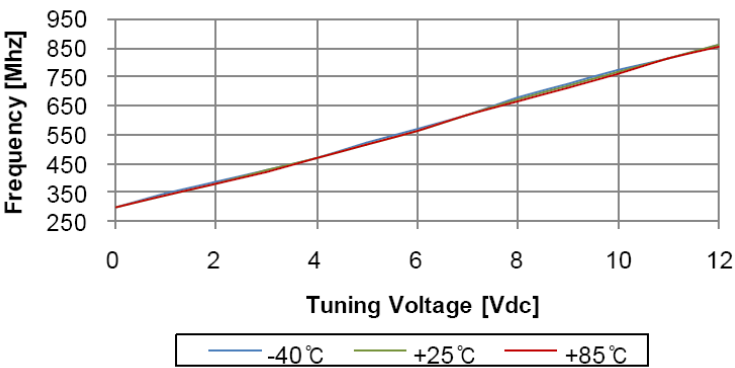

Output Power Curve

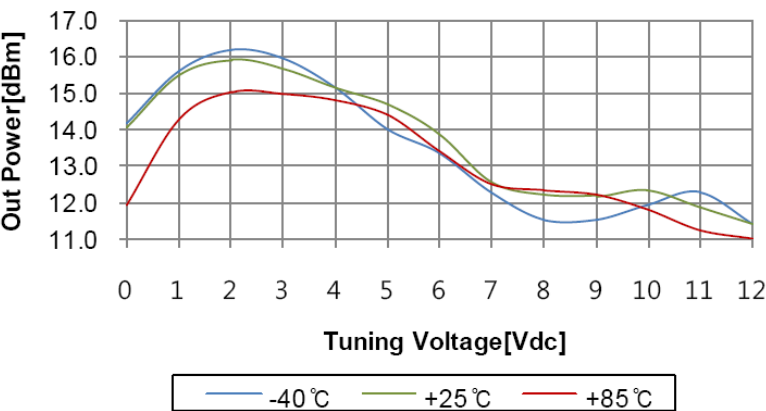

Phase Noise Plot

